

DEPARTMENT OF TRANSPORTATION STATE OF GEORGIA

RIGHT OF WAY OF PROPOSED KENNESAW MOUNTAIN TO CHATTAHOOCHEE RIVER TRAIL UNIVERSITY SECTION

PROJECT NO. CM000-00BK-00(027)

STATE	PROJECT NUMBER	SHEET NO.	TOTAL SHEETS
GA.	CM000-00BK-00 (027)	1	7

CONVENTIONAL SIGNS	
STATE OR COUNTY LINE	-----
CITY LIMIT LINE	-----
LAND LOT LINE	-----
PROPERTY LINE	-----
SURVEY OR BASE LINE	-----
RIGHT OF WAY LINE	EXISTING ----- REQUIRED -----
LIMIT OF ACCESS	---o---o---
REDD R/W & LIMIT OF ACCESS	---x---x---
R/W MARKERS	---x---x---
FENCE	---x---x---
RAILROAD	---x---x---
POWER LINE	---p---p---
TELEPHONE LINE	---t---t---
POWER POLES	---p---p---
TELEPHONE OR TELEGRAPH POLES	---t---t---

69-69

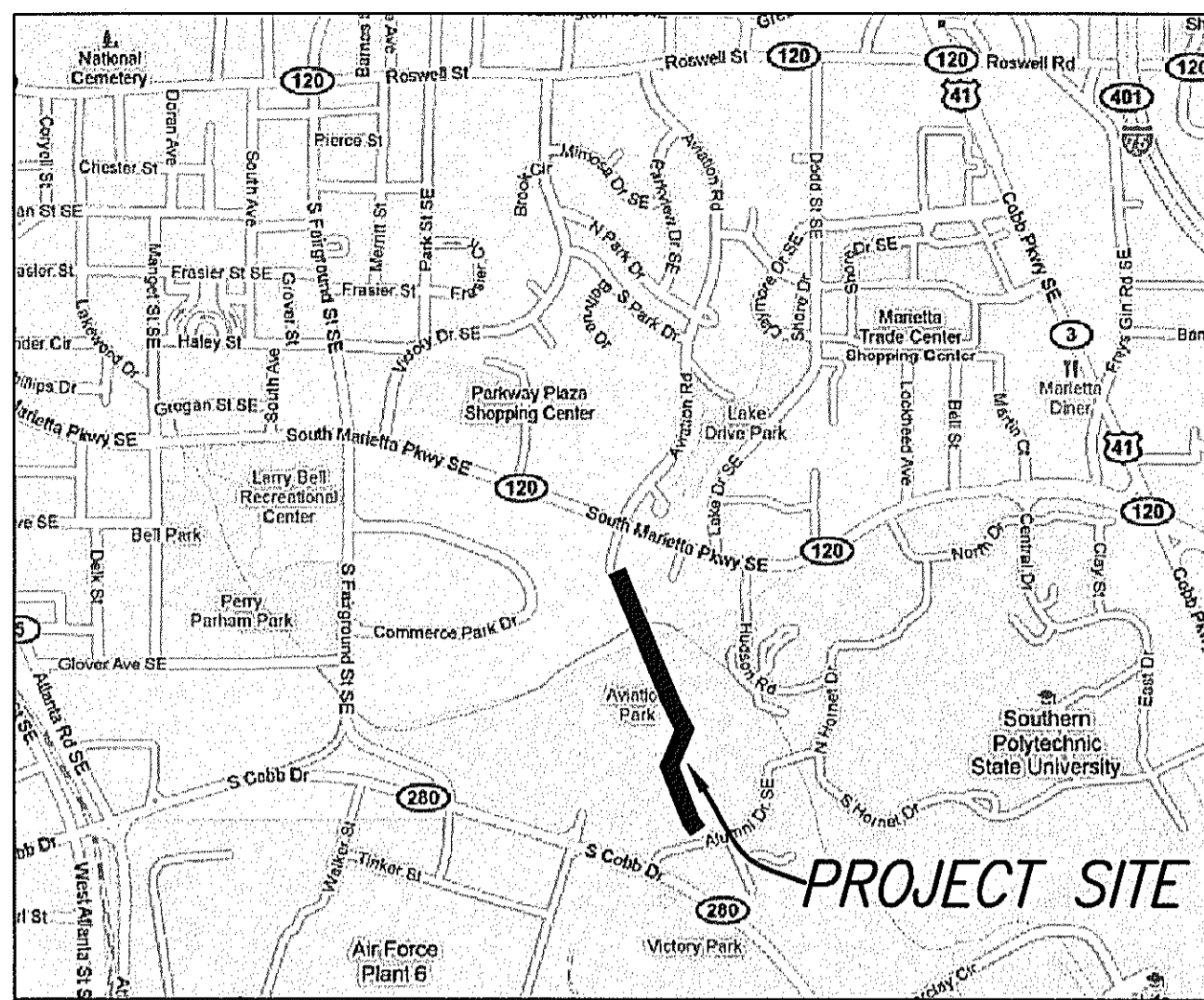

LOCATION SKETCH

NOTE: THIS PROJECT IS LOCATED IN THE WEST ZONE OF THE GEORGIA STATE PLANE COORDINATE SYSTEM
HORIZONTAL DATUM: NAD 1927
VERTICAL DATUM: NAVD 1988

NOTE: ALL WORK TO BE DONE IN ACCORDANCE WITH THE STANDARD SPECIFICATIONS OF THE DEPARTMENT OF TRANSPORTATION OF GEORGIA CURRENT EDITION AS APPROVED BY THE FEDERAL HIGHWAY ADMINISTRATION

THIS PROJECT HAS BEEN DESIGNED TO COMPLY WITH THE TITLE II PROVISIONS OF AMERICANS WITH DISABILITY ACT (ADA).

PROJECT DESIGNATION: EXEMPT

THIS PROJECT IS LOCATED 100% IN THE CITY OF MARIETTA, CONGRESSIONAL DISTRICT 6

DESIGNED IN ENGLISH UNITS

PROJECT NARRATIVE:
CONSTRUCTION ACTIVITIES INCLUDES CONSTRUCTION OF PHASE II OF A MULTI-USE BIKE TRAIL.

ALL REFERENCES IN THIS DOCUMENTS, WHICH INCLUDES ALL PAPERS, WRITINGS, DOCUMENTS, DRAWINGS, OR PHOTOGRAPHS USED, OR TO BE USED IN CONNECTION WITH THIS DOCUMENT, TO "STATE HIGHWAY DEPARTMENT OF GEORGIA", "STATE HIGHWAY DEPARTMENT", "GEORGIA STATE HIGHWAY DEPARTMENT", "HIGHWAY DEPARTMENT", OR "DEPARTMENT" WHEN THE CONTEXT THEREOF MEANS THE STATE HIGHWAY DEPARTMENT OF GEORGIA MEAN, AND SHALL BE DEEMED TO MEAN THE DEPARTMENT OF TRANSPORTATION.

THE DATA, TOGETHER WITH ALL OTHER INFORMATION SHOWN ON THESE PLANS OR IN ANYWAY INDICATED THEREBY, WHETHER BY DRAWINGS OR NOTES, OR IN ANY OTHER MANNER, ARE BASED UPON FIELD INVESTIGATIONS AND ARE BELIEVED TO BE INDICATIVE OF ACTUAL CONDITIONS. HOWEVER, THE SAME ARE SHOWN AS INFORMATION ONLY, ARE NOT GUARANTEED, AND DO NOT BIND THE DEPARTMENT OF TRANSPORTATION IN ANY WAY. THE ATTENTION OF BIDDER IS SPECIFICALLY DIRECTED TO SUBSECTIONS 102.04, 102.05, AND 104.03 OF THE SPECIFICATIONS.

PROJECT #CM000-00BK-00 (027), COBB COUNTY

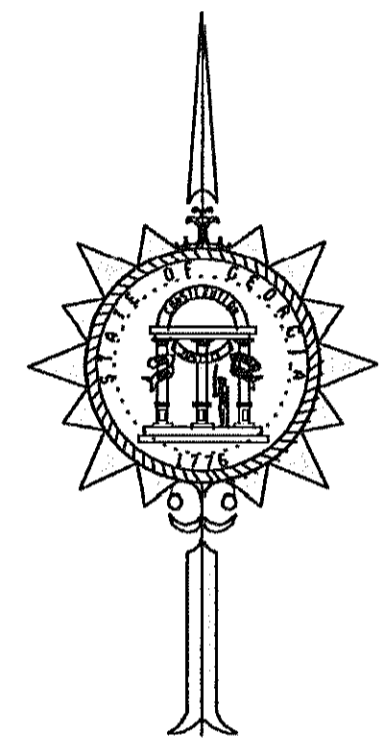
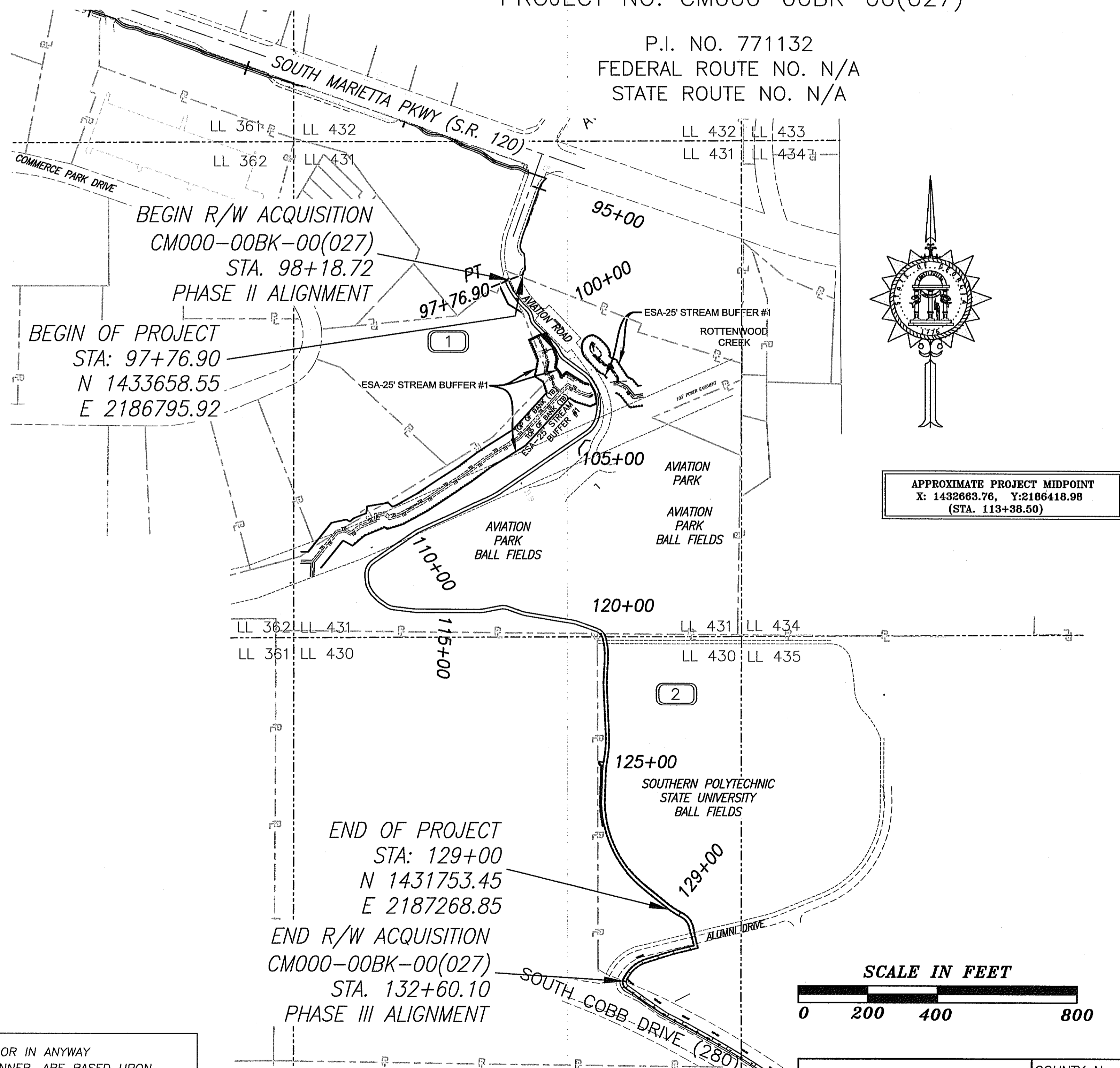

APPROXIMATE PROJECT MIDPOINT
X: 1432663.76, Y: 2186418.98
(STA. 113+38.50)

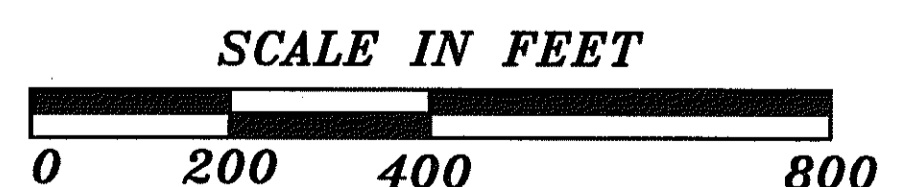

LENGTH OF PROJECT COBB COUNTY	COUNTY No. 067
	MILES
NET LENGTH OF PROJECT RIGHT-OF-WAY	0.59
NET LENGTH OF EXCEPTIONS	0.000
GROSS LENGTH OF PROJECT RIGHT-OF-WAY	0.59



2120 POWERS FERRY ROAD, SUITE 100
ATLANTA, GA. 30339
(770) 955-5574
Office Locations: * North Carolina * South Carolina * Georgia

PLANS PREPARED BY: A. HENNINGTON



PROFESSIONAL ENGINEER STAMP/SEAL

UNDER THE SUPERVISION OF
DAVID R. BRASWELL, P.E.

APPROVED: *Howard P. Copeland*
HOWARD P. COPELAND, STATE RIGHT OF WAY ADMINISTRATOR
DATE: Feb 02, 2011

LOCATION AND DESIGN APPROVAL DATE:	7/1/2004
PLANS COMPLETED	12/1/2010
REVISIONS	DATE

69-69